

# INFKL

## Infrared Temperature Sensor

INFKL-###

SN: I#####

Texense sensors are designed for data logging. Should the users want to include this sensor in a closed loop system, they must undertake total responsibility from doing so.

Measurement features		
Range	150, 200, 800	°C
Accuracy	±3	%FS
Sensitivity at +Full-scale	30, 20, 5	mV/°C
Response time	100	ms
Sensitive Element	Thermopile with silicon lens	
Wave Length	8 to 14	µm
Measurement distance	30 to 150	mm
Field of view (90% radiation)	2.5 : 1	
Calibrator Reference	Ranges 150, 200	Land P550P
	Range 800	Land R1200P
Calibrator Emissivity	99%	
Electrical features		
Supply Voltage	6	V
Supply Current	1.5	mA
Protection	Reverse voltage and short circuit protection	
Output signal	0-5	V
Mechanical features		
Dimensions	20 x 16 x 12	mm
Material	Aluminum	
Weight (without cable)	15	g
Environmental features		
Protection	IP64	
Vibration test	20Gpp 5'	
Shock	500	G
Operating Temp	150, 200	0 to +40
	800	0 to +60
Storage Temp	-40 to +125	
		°C

Date		Operator	
Customer			
Order			
Ref	INFKL-###		

Sensor readings	
Calibrator temperature (°C)	Signal output value (V)
...°C	...V
...°C	...V

Cable		
3x26AWG FEP tinned copper braided cable 250V 200°C		
Length: 1000 mm ±10%		Tubing: None
Connector: N/A		
Color	Function	Pin
Red	Supply	-
White	Signal	-
Black	0V	-
Braid		-

Calibration table			
Target temperature (°C)	Voltage per range (V)		
	150 (30mV/°C)	200 (20mV/°C)	800 (5mV/°C)
0	0.40	0.50	0.50
20	1.00	0.90	0.60
40	1.60	1.30	0.70
60	2.20	1.70	0.80
80	2.80	2.10	0.90
100	3.40	2.50	1.00
150	4.90	3.50	1.25
200		4.50	1.50
400			2.50
600			3.50
800			4.50

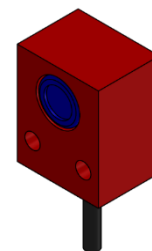

**Mechanical drawing**

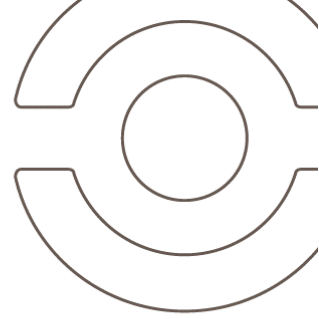
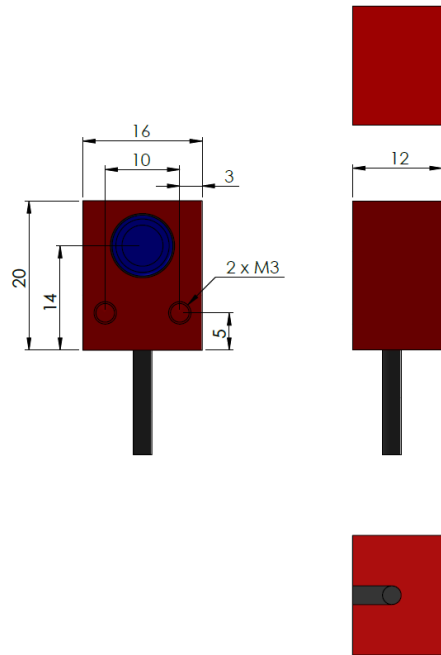

**FOV (field of view)**

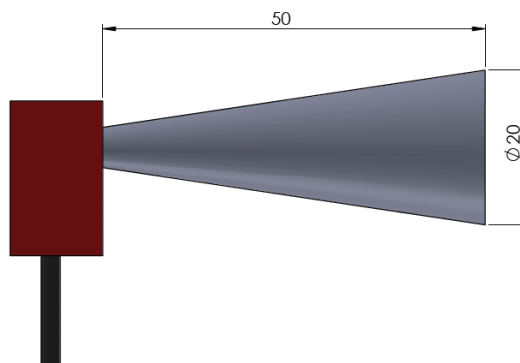

**Ordering information**

**Ordering ref:**

INFKL-Range

150: 150°C  
200: 200°C  
800: 800°C